

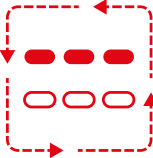





Valera+ 
PROFESSIONAL

VANITYCARE AI

QUICK START GUIDE

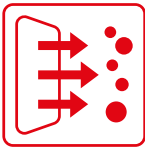

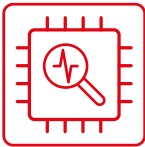
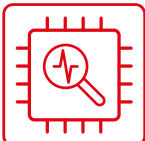
Auto check		AUTO CHECK DIAGNOSTIC	1
CARE Dual Setting		DUAL SETTING CARE & MAX	2
MAX Dual Setting		DUAL SETTING CARE & MAX	3
Impostazione diffusore			4
Clean Filter		CLEAN FILTER EASY & AUTOMATIC	5
Manual Cleaning		CLEAN FILTER MANUAL	6
Diagnostics 1/2			7
Diagnostics 2/2			8

Auto check

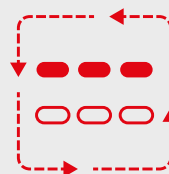

AUTO CHECK
DIAGNOSTIC

1

Plug-in/Check

Each time the plug is reinserted into the socket (20 seconds after the last time it was removed), the hairdryer automatically checks its functions. The self-checking LED lights flash in quick succession.

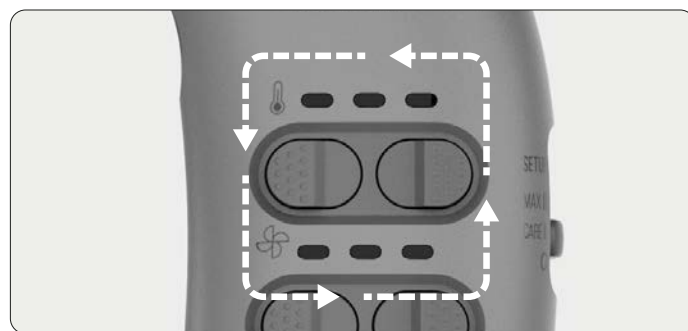

Check/Off

When switching off, the motor continues to run for a few seconds to cool down the components. The self-checking LEDs flash in quick succession until the appliance is completely switched off.

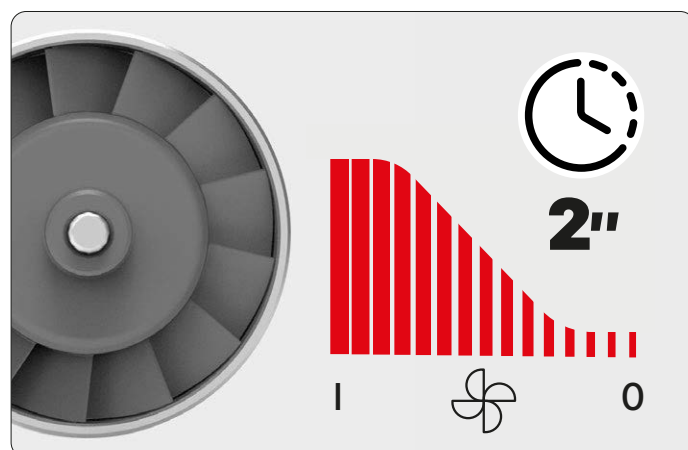
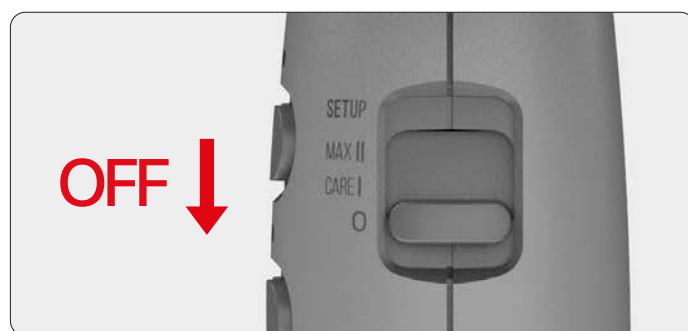

CARE

Dual Setting



DUAL SETTING
CARE & MAX

For hair type appropriate treatment two settings - CARE and MAX - are available, each with 9 combinations of temperature and airflow, 18 in total.

CARE

For fine, delicate or coloured hair. 9 balanced, gradually increasing combinations.

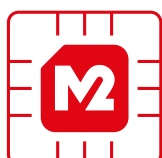
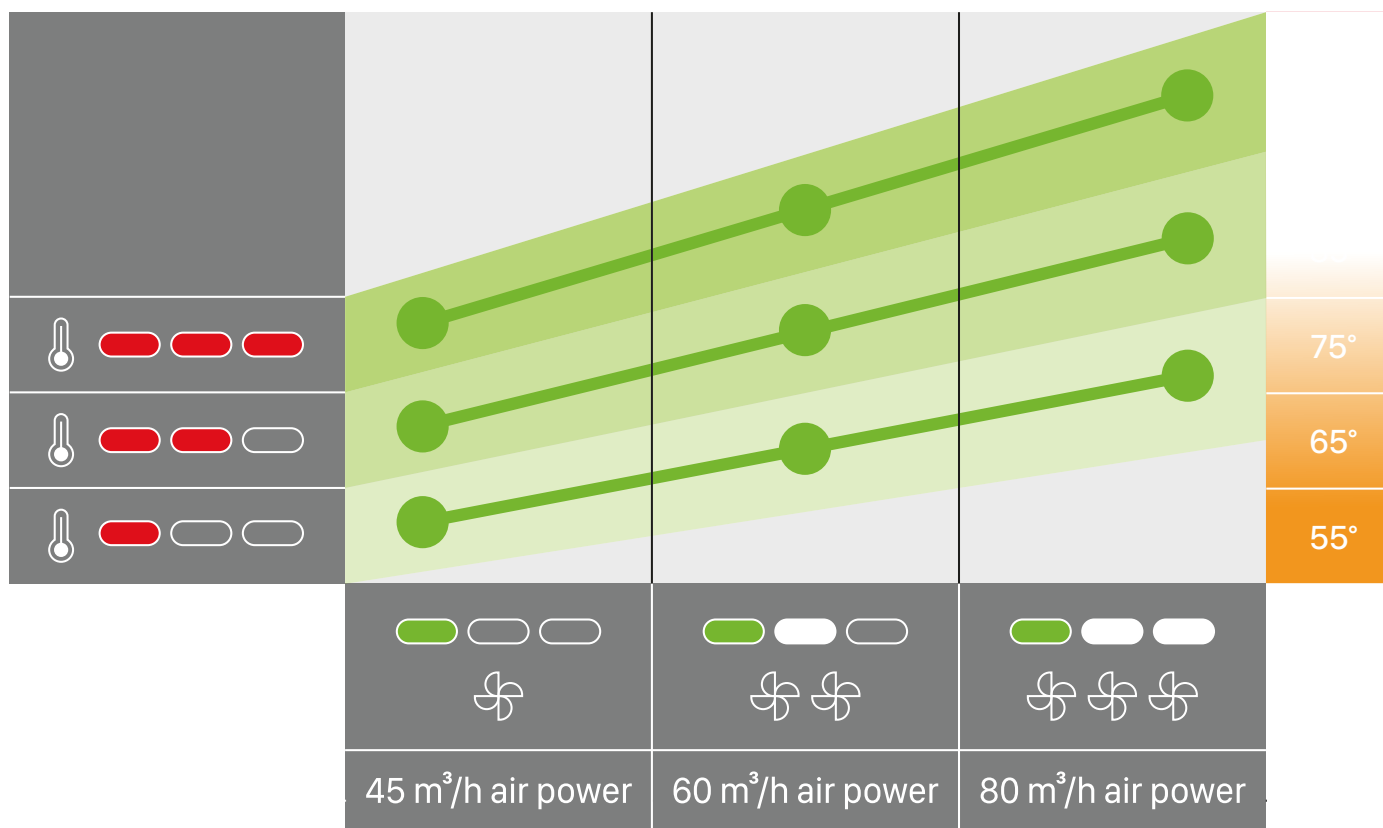
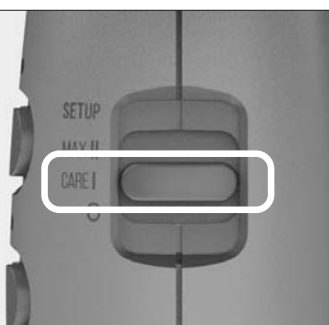

DUAL MEMORY FUNCTION

The hairdryer memorises the last combination of temperature and fan for both CARE and MAX settings. It is therefore possible to preset the two most frequently used combinations and simply switch from one to the other using the CARE/MAX selector switch

MAX

Dual Setting



DUAL SETTING
CARE & MAX

For hair type appropriate treatment two settings - CARE and MAX - are available, each with 9 combinations of temperature and airflow, 18 in total.

MAX

For strong, thick hair. Temperature, set at a higher level, and airflow are separately adjustable in 9 combinations.

	●──────────────────●──────────────────●			75°	
	●──────────────────●──────────────────●				65°
	●──────────────────●──────────────────●				55°
	45 m ³ /h air power	60 m ³ /h air power	80 m ³ /h air power		

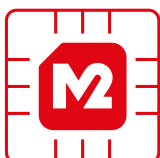

DUAL MEMORY FUNCTION

The hairdryer memorises the last combination of temperature and fan for both CARE and MAX settings. It is therefore possible to preset the two most frequently used combinations and simply switch from one to the other using the CARE/MAX selector switch

Diffuser Setting



4



For optimum drying and styling with the diffuser, we recommend the CARE setting with the combination:

Fan level 1

Temperature level 3



Clean Filter

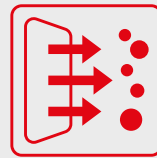

CLEAN FILTER
EASY & AUTOMATIC

5

Filter cleaning function by reversing the airflow direction.

1. Indicator light

After 20 hours of hairdryer operation, the "clean filter" LED light flashes orange.



2. Start cleaning

Keep the "clean filter" button pressed for at least 2 seconds, and filter cleaning will start automatically.

ATTENTION: Automatic cleaning can only be started when the "clean filter" LED light flashes orange.



3. Automatic cleaning

During airflow reversal, the LED remains solid orange without blinking.



4. End

Once the cleaning cycle is completed, the "clean filter" LED turns green for 2 seconds before turning off.

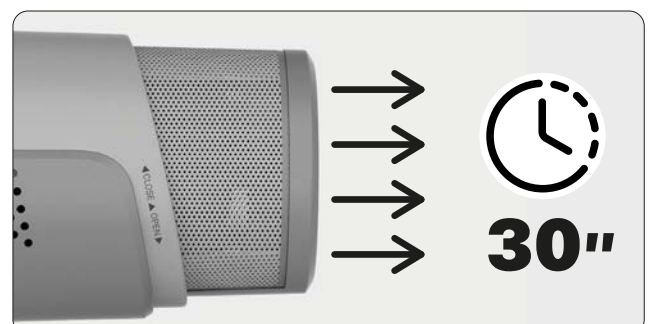

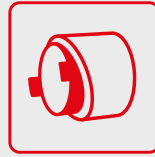

The air intake filter must always be kept free of impurities. In addition to the programmed self-cleaning function, frequent manual cleaning is recommended.

1. Remove

The filter can be removed by slightly turning it counterclockwise.

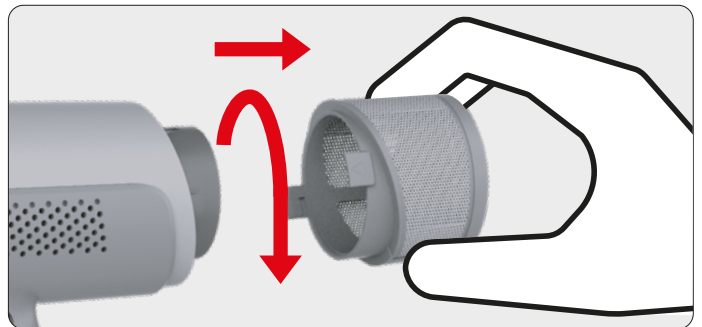

2. Brush

Remove dust and hair with a cleaning brush.

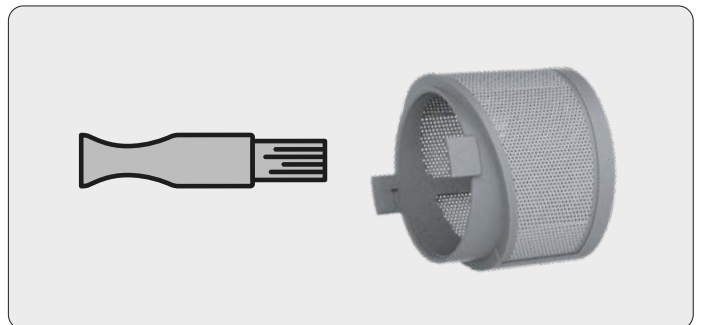

3. Replace

Reposition the clean filter, turn it clockwise and gently tighten it.

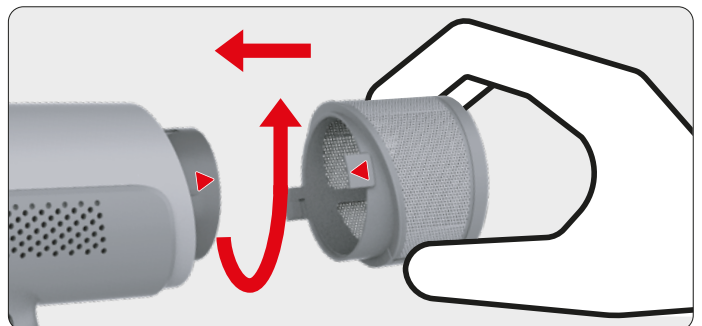

CAUTION

The hairdryer must always be used with the filter. Using it without a filter will irreparably damage it and invalidate the manufacturer's warranty.

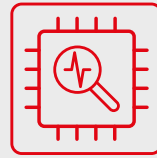

If the hairdryer locks, the LED lights identify the problem.



**Hardware protection
against current peaks**



**Software protection
against current peaks**



Overcurrent



Low voltage

Reset appliance*

- Switch off the hairdryer
- Pull the plug out of the socket
- Wait for 30 seconds
- Insert the plug into the socket
- Switch on the hairdryer

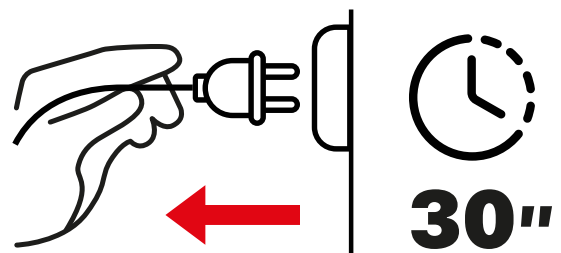

(*) In case the problem persists, contact support.

Diagnostics 2/2

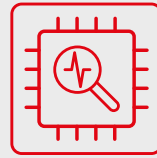

8

If the hairdryer locks, the LED lights identify the problem.



Motor blocked

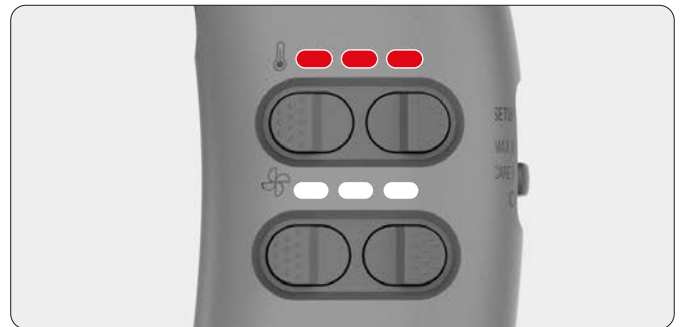

Phase anomaly



Other

The hairdryer must undergo maintenance in a Valera service centre.

